

SEC 18, TWP. 45 S., RGE 43 E.

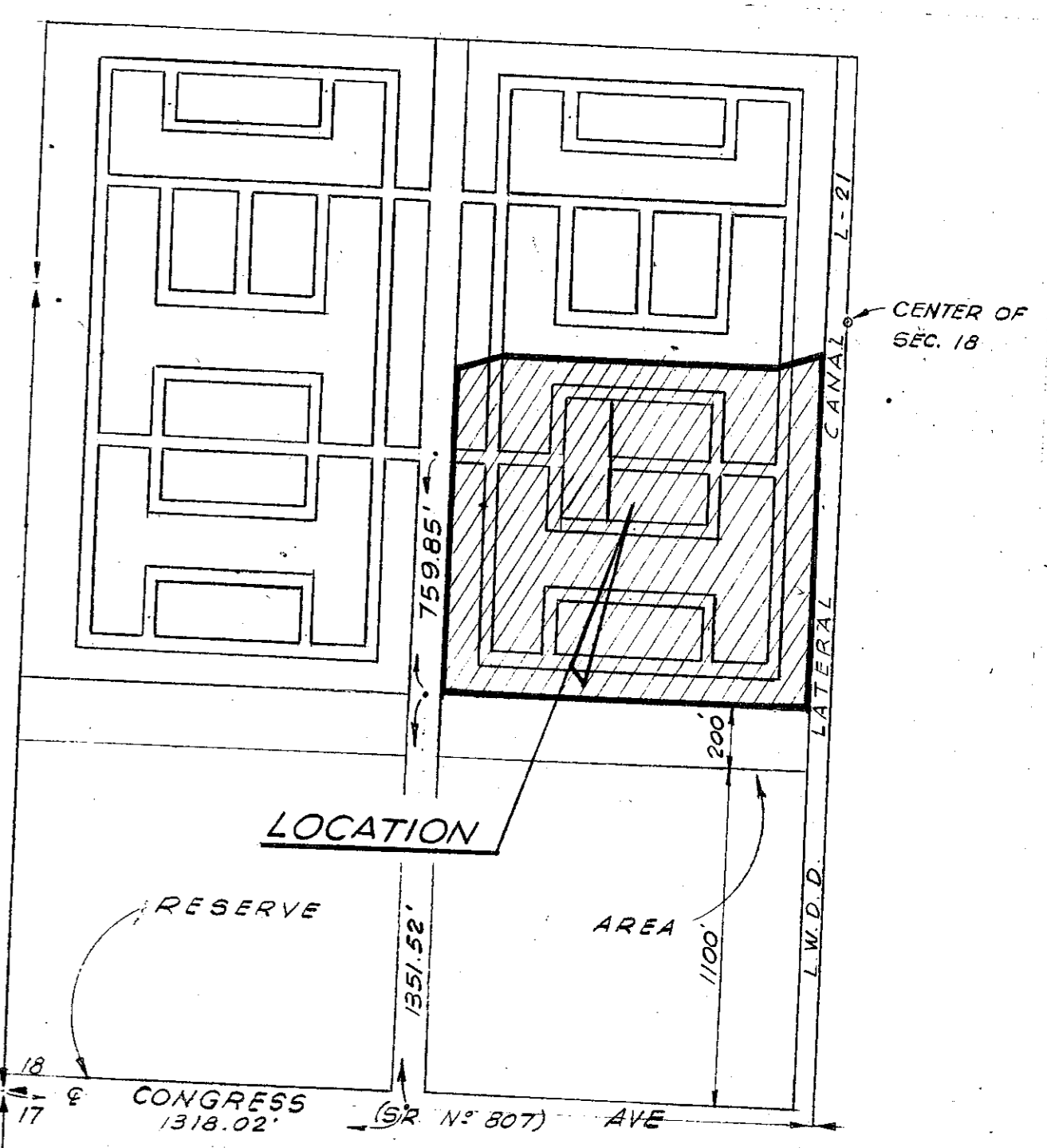

1 1/2 MILES TO BOWEN ROAD

LOCATION MAP
SCALE: 1" = 500'

CURVE DATA

- "A" Δ=87°22'19" R=45.00' T=42.98' Arc=68.82'
- "B" Δ=92°37'41" R=45.00' T=47.11' Arc=72.75'
- "C" Δ=92°42'59" R=45.00' T=47.19' Arc=72.82'
- "D" Δ=87°17'01" R=45.00' T=42.92' Arc=68.55'

FILE COPY

PETITION NO. 79-290
DATE SUBMITTED 11.1.79
EXHIBIT NO. 4A

NOTE: DELETED LOTS 147, 158, 159 AND 170

195 LOTS

- BENCH MARKS**
- №1 - DISC IN N.E. WINGWALL OF BOX CULVERT @ CONGRESS AVE. & L.W.D.D. LAT. № 22 ELEV. = 13.23
 - №2 - TOP BOX CULVERT @ CONGRESS AVE. & L.W.D.D. LAT. № 21 ELEV. = 13.10

PHASE I

MOCK, ROOS & SEARCY, INC.

FORMERLY
K. C. MOCK & ASSOCIATES, INC.
CONSULTING ENGINEERS
WEST PALM BEACH

PROPOSED LAYOUT
FOR SAND & SEA VILLAGE
MOBILE HOME COMMUNITY
PALM BEACH COUNTY, FLORIDA

3 APR 70	JBC	REVISED WIDTH OF 34TH AVE SO & 34TH DR SO TO 30'
26 FEB 69	JBC	GENERAL REVISION
6 MAY 69	JBC	DELETED LOTS 147, 158, 159 & 170

17 MAR 69	NGS	BEARINGS, DIMENSIONS & CURVE DATA
26 FEB 69	JBC	GENERAL REVISION
DATE	BY	DESCRIPTION
		REVISIONS

REF. PLAT	SCALE: 1" = 60'	DATE: MAY 1969	DWG. NO. 25-23-13-5
CHECK: E.J.R.	JOB NO. 69-38		
DR. BY: D.S.-J.B.C.			SHEET 2 of 5